

Type Number..... 337
Designation IEC..... ---
System..... Silver oxide/ Zinc /
 NaOH - Electrolyte

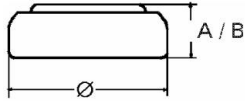

Nominal Voltage..... 1,55 V
Typical Capacity C..... 9 mAh
 Load 68.1 k Ω , at 20°C down to 1.2 V

Weight (approx.)..... 0,13 g
Volume.....
Coding..... Date of Manufacturing
 Month/Year

Temperature Ranges min max.
 Storage..... 0°C 60°C
 Discharge..... 0°C 60°C

Dimensions min max.
 Diameter (Ø)..... 4,65 4,80
 Height (A/B)..... 1,47 1,65

Typical Capacities (at 20°C)

| Discharge Type | Load | End Voltage: 1.2V | |
|---------------------------|----------------|-------------------|--------|
| Continuous 24h/d, 7d/w | 68100 Ω | Time: | 402 h |
| | | Capacity: | 9 mAh |
| | | Energy: | 14 mWh |

No publication or circulation of data to third parties without consent of VARTA Consumer Batteries

All Data contained herein is for single cells For battery applications, performance data may vary from single cell data, depending on specific battery configuration